

| Design Data | |
|-----------------------|-------------------|
| Commutation | Brushed |
| Direction of rotation | Bi-directional |
| Bearing type | A:Ball - B:Sleeve |

| Performance data | | |
|-------------------------------------|-------|-------|
| Rated voltage [V] | U_N | 24 |
| Nominal torque [Nm] | M_N | 4.00 |
| No-load speed [min^{-1}] | n_0 | 190.0 |
| Nominal power [W] | P_N | 73.1 |
| Nominal current [A] | I_N | 7.0 |
| Nominal force [kN] | F_N | 0.00 |
| Duty cycle | s1 | |

| Sensor data | |
|-----------------|---|
| Pulses | 0 |
| Output channels | 0 |

| Other data | |
|------------------------|------------------|
| Gear ratio | 103/4 |
| Gear wheel material | plastic |
| Suppression components | 4,7 μ H, 1nF |
| Enclosure class | IP 40 |
| Weight [kg] | 1.700 |

Remarks:

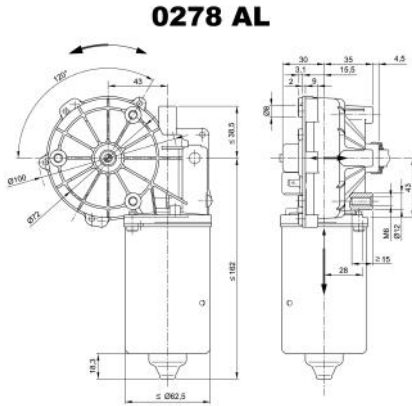

Motor picture



Characteristic curves

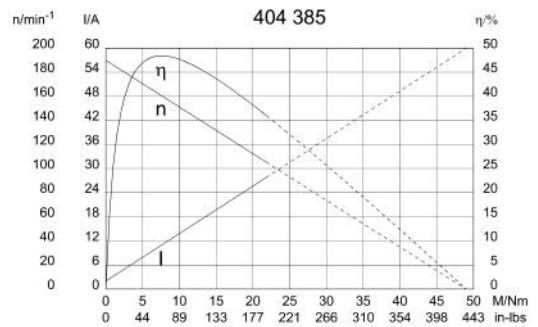

Output shaft drawing (W), Wiring diagrams (S) and Connector layout (K)

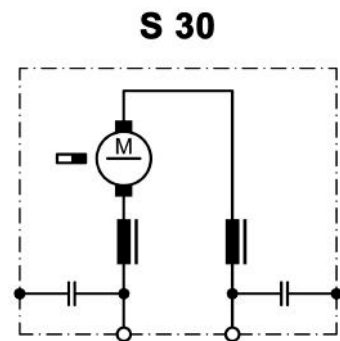
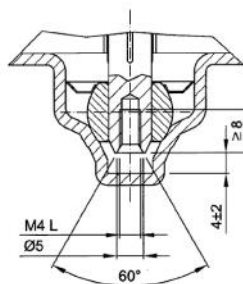
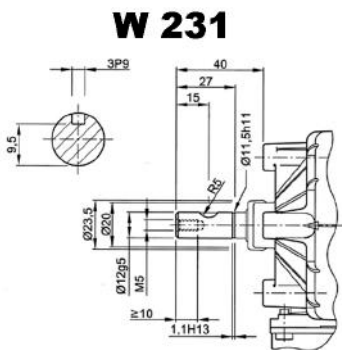

! Lefthand thread

