

External Locking Assembly MAV 3022 standard duty

rev. 1

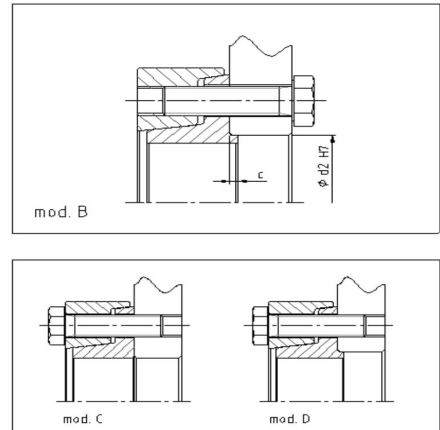
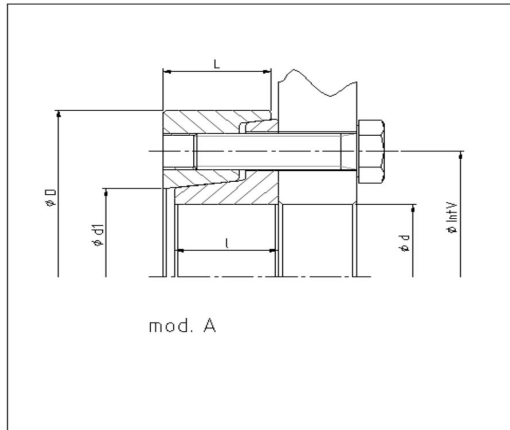

2-part design, 4 models available

Not self-locking

Screws ISO 4014/4017 grade 10.9

Screws & tapers greased with MoS₂

Shaft & hub contact surfaces: GREASE-FREE and DRY

Axial fixation of hub during tightening: yes

Max shaft tolerance: h9

Shaft / hub surface finish: $0.8 \leq Ra \leq 3.2 \mu\text{m}$

Transmissible torque is given by min. capacity

of shaft/lock.ass'y or hub/lock.ass'y contact surfaces

For narrow hub connections (ex. sprockets, brake discs)

⁽¹⁾ screws length for model C and D

Ma: screw tightening torque

Mt: transmissible torque

Example of order: MAV 3022 - 70 x 115 mod. A, B, C or D, hub width for mod. A and B

DIMENSIONS								SCREWS			PERFORMANCES	WEIGHT
d x D	L	IntV	l	d1	c	d2	No.	size ⁽¹⁾	Ma	Mt		
mm	mm	mm	mm	mm	mm	mm			Nm	Nm	kg	
12 x 35	11	24	10	13	2	14	3	M 6 x 20	12	70	0,1	
11 x 35	11	24	10	13	2	14	3	M 6 x 20	12	70		
14 x 38	12	26	11	15	2	16	3	M 6 x 20	12	80	0,1	
13 x 38	12	26	11	15	2	16	3	M 6 x 20	12	80		
16 x 41	15	28	14	17	2	18	3	M 6 x 25	12	90	0,1	
15 x 41	15	28	14	17	2	18	3	M 6 x 25	12	90		
18 x 44	15	30	14	19	2	20	4	M 6 x 25	12	120	0,1	
18 x 44	15	30	14	19	2	20	4	M 6 x 25	12	120		
20 x 47	15	32	14	21	2	22	4	M 6 x 25	12	130	0,2	
19 x 47	15	32	14	21	2	22	4	M 6 x 25	12	130		
25 x 50	19	36	18	26	2	27	5	M 6 x 30	12	190	0,2	
24 x 50	19	36	18	26	2	27	5	M 6 x 30	12	190		
21 x 50	19	36	18	26	2	27	5	M 6 x 30	12	190		
30 x 60	19	44	18	32	3	32	6	M 6 x 30	12	270	0,3	
28 x 60	19	44	18	32	3	32	6	M 6 x 30	12	270		
26 x 60	19	44	18	32	3	32	6	M 6 x 30	12	270		
36 x 72	21	52	20	38	3	38	5	M 8 x 35	30	560	0,5	
35 x 72	21	52	20	38	3	38	5	M 8 x 35	30	550		
31 x 72	21	52	20	38	3	38	5	M 8 x 35	30	471		
44 x 80	23	61	22	47	3	46	6	M 8 x 35	30	730	0,6	
40 x 80	23	61	22	47	3	46	6	M 8 x 35	30	730		
37 x 80	23	61	22	47	3	46	6	M 8 x 35	30	730		
50 x 90	25	68	24	53	3	53	8	M 8 x 40	30	1.080	0,9	
45 x 90	25	68	24	53	3	53	8	M 8 x 40	30	1.080		
42 x 90	25	68	24	53	3	53	8	M 8 x 40	30	1.080		
55 x 100	27	72	26	58	3	58	8	M 8 x 40	30	1.140	1,2	
52 x 100	27	72	26	58	3	58	8	M 8 x 40	30	1.140		
45 x 100	27	72	26	58	3	58	8	M 8 x 40	30	1.140		
62 x 110	27	80	26	66	3	63	9	M 8 x 40	30	1.430	1,4	
60 x 110	27	80	26	66	3	63	9	M 8 x 40	30	1.430		
50 x 110	27	80	26	66	3	63	9	M 8 x 40	30	1.430		
70 x 115	27	86	26	72	4	74	9	M 8 x 40	30	1.540	1,4	
65 x 115	27	86	26	72	4	74	9	M 8 x 40	30	1.540		
60 x 115	27	86	26	72	4	74	9	M 8 x 40	30	1.540		
80 x 141	29	100	28	84	4	84	10	M 10 x 45	59	3.510	2,2	
75 x 141	29	100	28	84	4	84	10	M 10 x 45	59	3.450		
70 x 141	29	100	28	84	4	84	10	M 10 x 45	59	3.370		

External Locking Assembly MAV 3022 standard duty

rev. 1

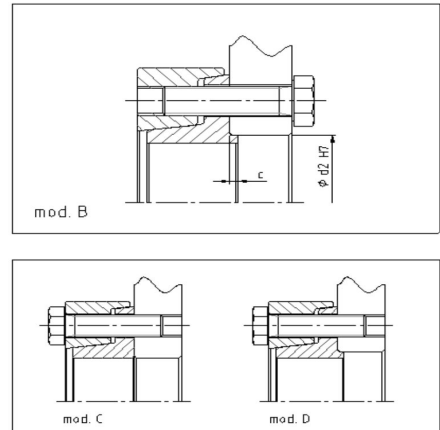
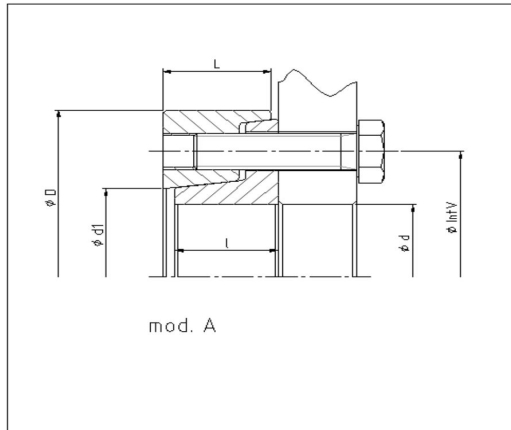

2-part design, 4 models available

Not self-locking

Screws ISO 4014/4017 grade 10.9

Screws & tapers greased with MoS₂

Shaft & hub contact surfaces: GREASE-FREE and DRY

Axial fixation of hub during tightening: yes

Max shaft tolerance: h9

Shaft / hub surface finish: $0.8 \leq Ra \leq 3.2 \mu\text{m}$

Transmissible torque is given by min. capacity

of shaft/lock.ass'y or hub/lock.ass'y contact surfaces

For narrow hub connections (ex. sprockets, brake discs)

⁽¹⁾ screws length for model C and D

Ma: screw tightening torque

Mt: transmissible torque

Example of order: MAV 3022 - 70 x 115 mod. A, B, C or D, hub width for mod. A and B

DIMENSIONS								SCREWS			PERFORMANCES	WEIGHT
d x D	L	IntV	l	d1	c	d2	No.	size ⁽¹⁾	Ma	Mt		
mm	mm	mm	mm	mm	mm	mm			Nm	Nm	kg	
90 x 155	35	114	34	94	4	94	12	M 10 x 50	59	4.660	3,4	
85 x 155	35	114	34	94	4	94	12	M 10 x 50	59	4.590		
80 x 155	35	114	34	94	4	94	12	M 10 x 50	59	4.520		
100 x 170	40	124	39	104	4	104	12	M 12 x 60	100	7.440	5	
95 x 170	40	124	39	104	4	104	12	M 12 x 60	100	7.330		
90 x 170	40	124	39	104	4	104	12	M 12 x 60	100	7.230		
110 x 185	47	136	45	114	5	116	12	M 12 x 70	100	8.120	6	
105 x 185	47	136	45	114	5	116	12	M 12 x 70	100	8.020		
100 x 185	47	136	45	114	5	116	12	M 12 x 70	100	7.910		
125 x 215	50	160	48	134	5	126	12	M 16 x 75	250	18.010	9	
120 x 215	50	160	48	134	5	126	12	M 16 x 75	250	17.800		
115 x 215	50	160	48	134	5	126	12	M 16 x 75	250	17.600		
140 x 230	54	172	52	146	5	146	14	M 16 x 80	250	22.780	11	
135 x 230	54	172	52	146	5	146	14	M 16 x 80	250	22.530		
130 x 230	54	172	52	146	5	146	14	M 16 x 80	250	22.290		
160 x 263	58	192	56	165	5	166	15	M 16 x 80	250	27.900	15	
155 x 263	58	192	56	165	5	166	15	M 16 x 80	250	27.640		
150 x 263	58	192	56	165	5	166	15	M 16 x 80	250	27.380		
170 x 290	62	204	61	175	5	176	16	M 16 x 90	250	32.460	21	
165 x 290	62	204	61	175	5	176	16	M 16 x 90	250	32.180		
160 x 290	62	204	61	175	5	176	16	M 16 x 90	250	31.910		
180 x 300	62	218	61	185	5	186	18	M 16 x 90	250	38.040	22	
175 x 300	62	218	61	185	5	186	18	M 16 x 90	250	37.720		
170 x 300	62	218	61	185	5	186	18	M 16 x 90	250	37.410		
190 x 320	79	232	76	195	5	196	15	M 20 x 110	490	52.760	32	
185 x 320	79	232	76	195	5	196	15	M 20 x 110	490	52.350		
180 x 320	79	232	76	195	5	196	15	M 20 x 110	490	51.950		
200 x 340	79	246	76	210	5	206	16	M 20 x 110	490	59.630	37	
195 x 340	79	246	76	210	5	206	16	M 20 x 110	490	59.190		
190 x 340	79	246	76	210	5	206	16	M 20 x 110	490	58.770		
220 x 370	98	270	95	230	5	226	14	M 24 x 130	840	81.950	53	
210 x 370	98	270	95	230	5	226	14	M 24 x 130	840	80.870		
200 x 370	98	270	95	230	5	226	14	M 24 x 130	840	79.800		